

## Walls or ceiling panels' Mounting Instructions

Panel does not include fixing accessories (glue and/or double-sided adhesive tape)

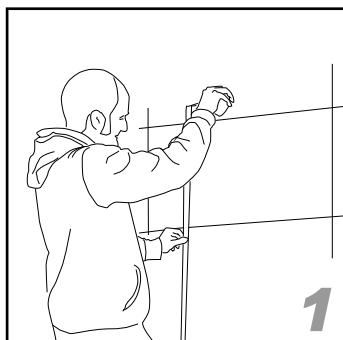

Mark the measurements of the place (wall or ceiling) where you want to install the panel by using a tape-measure.

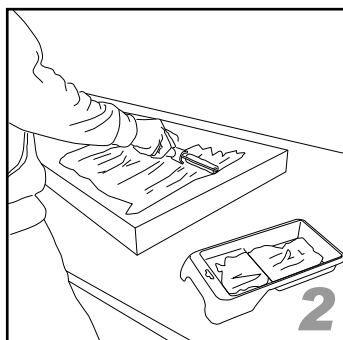

On a workbench apply mounting glue on the back of the panel all over the surface homogeneously.

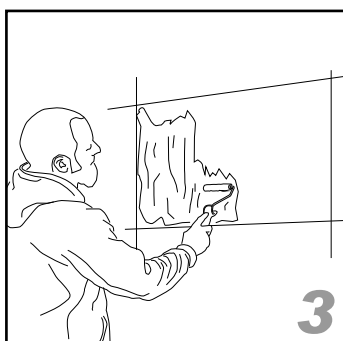

In the area previously marked apply mounting glue similarly as you did before on the panel...homogeneously.

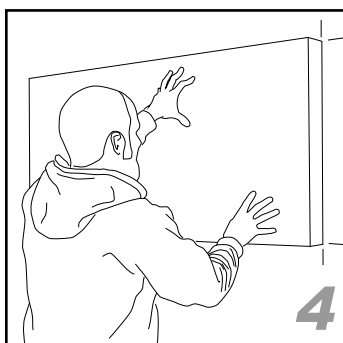

...at last, center the panel with the marks and press it to complete the operation. And that's it!

### WARNINGS:

- \* THE RECOMMENDED GLUE IS CONTACT ADHESIVE, FLAMMABLE, THAT RELEASES SOLVENTS AND SOME ODORS WITH IT.
- \* WE RECOMMEND AERATION OF SPACE DURING APPLICATION AND DRYING.
- \* RECOMMENDS THE USE OF MASKS WITH RECOMMENDED FILTER TYPE.